

## CELL VENTS

### Weep-Hole Ventilator

#### Product Description

Dur-O-Wal's Vent is designed to ensure moisture entering or exiting the cavity will pass over the exterior veneer rather than drop into the core which may cause efflorescence or spalling. Cell Vent is manufactured from flexible ultra violet resistant polypropylene co-polymer.

#### Benefits

- The shape ensures the space between the masonry units is kept free of mortar.
- Available to suit all masonry veneer sizes whether they be brick, block or stone.
- Designed to be installed with the outside face to be 1/8" from the face of the masonry unit so the vent will be less visible and to eliminate dark shadow areas on the wall.
- Ease of installation for the mason
- Colors available subject to manufacturer's minimum
- Custom sizes are available subject to minimum production.

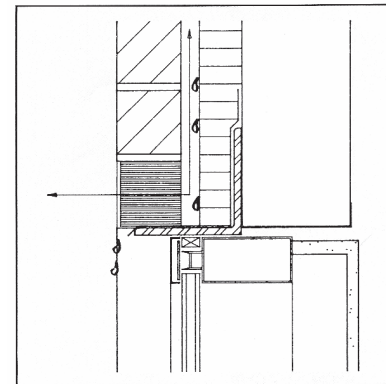
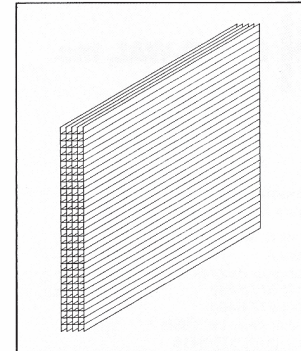

MASONRY

## INS-O-GRIPS AND DUR-O-STOP

### DA 2100 INS-O-GRIPS

Designed to hold rigid insulation against the backup and provide a cavity drip.

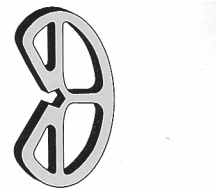

### DA 1015 DUR-O-STOP

Designed to prevent grout from falling through.  
Sizes: 4, 6, 9, and 12" x 150'

