

R-VALUE BRICK AND BLOCK CAVITY WALL

4" Clay Brick	0.44					
4" Block (115#/ft ³) = 72% solid	1.19					
6" Block (115#/ft ³) = 59% solid	1.34					
8" Block (115#/ft ³) = 54% solid	1.51					
10" Block (115#/ft ³) = 52% solid	1.61					
12" Block (115#/ft ³) = 48% solid	1.72					
1/2" Drywall	0.45					
Exterior Air Film (winter)	0.17					
Interior Air Film	0.68					
Dead Air Space (3/4" - 4") (winter)	0.97					
*Reflective Air Space	2.8					
Insulation Type Thickness (inches)	1/2	3/4	1	1 1/2	2	3
Polyisocyanurate (foil face)	3.3	5.0	6.5	9.5	13.0	19.0
Extruded Polystyrene	—	3.75	5.0	7.5	10.0	15.0

*Use this value when insulation has a foil backing directly adjacent to air space

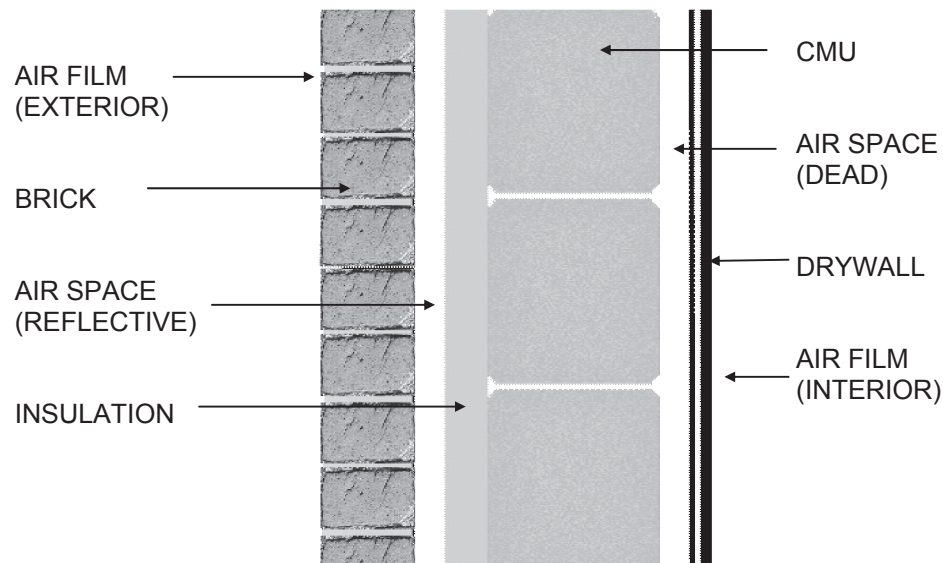

CALCULATIONS

R of the outside air film	= 0.17
R of 4" brick	= 0.44
R of 6" block	= _____ See Table
R of insulation	= _____ See Table
R of air space	= _____ See Table