

20H SYSTEM

Product Description

- 20H is a preformed expanding foam sealant produced by impregnating permanently elastic, high-density, open-cell polyurethane foam with water-based, polymer-modified asphalt.
- Partially filling the open-cells with the impregnation and then compressing the material results in levels of sealing depending on the degree of compression.
- Typically, approximately 5-times compression (20% of the material's uncompressed dimension) is required for water-tightness in below-grade and horizontal deck applications.
- The 20H foam is packaged precompressed in shrink-wrapped lengths (sticks).
- It is supplied precompressed to less than the nominal material size for easy insertion into the joint.
- Sealing between the foam and substrate is achieved through a combination of the effects of foam backpressure and the epoxy adhesive applied to the substrates and into which the 20H foam is installed
- The exposed or outer surface of the installed 20H is further treated with TOPCOAT, supplied to suit the application.

Applications

- As a watertight seal in joints including:

Decks

- structural joints
- perimeter joints
- roadways
- sidewalks
- parapets

Below-Grade

- foundation
- planters
- tunnels

- 20H is generally used as a primary seal. As such it is usually installed flush to the deck or below-grade wall surface.
- 20H can be used as a secondary seal and resilient support behind a bond breaker tape and caulking.
- Suitable for use in substrates of brick, CMU, precast and cast-in-place concrete, wood, and stone

Figure 1: 20H SYSTEM in Typical Installation

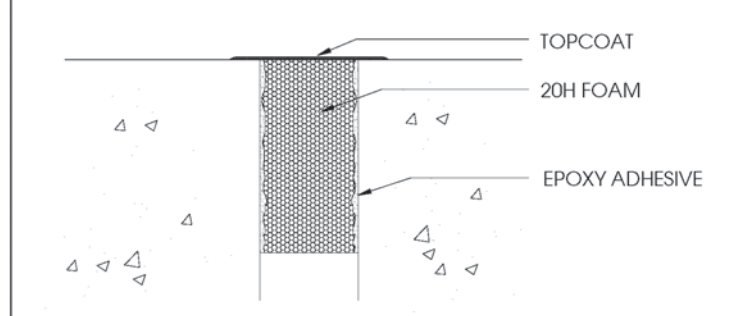

20H Sizing

Product Code	Nominal Material Size (Joint Size At Mean T°)	Depth of Seal
EH6040	1/2" (12mm)	1 1/2" (40mm)
EH7545	5/8" (15mm)	1 3/4" (45mm)
EH10050	3/4" (20mm)	2" (50mm)
EH12560	1" (25mm)	2 1/2" (60mm)
EH15060	1 1/4" (30mm)	2 1/2" (60mm)
EH19070	1 1/2" (40 mm)	2 3/4" (70mm)
EH22570	1 3/4" (45mm)	2 3/4" (70mm)
EH25070	2" (50mm)	2 3/4" (70mm)
EH28080	2 1/4" (55mm)	3 1/8" (80mm)
EH30080	2 1/2" (60mm)	3 1/8" (80mm)
EH34090	2 3/4" (70mm)	3 1/2" (90mm)
EH37590	3" (75mm)	3 1/2" (90mm)

NOTES:

- Select nominal material width to equal joint-gap width
- Supplied in shrink wrapped sticks of 6.56 lf (2 m)