

SONOSHIELD®
HLM 5000® (cont'd)

ORDER INFORMATION

HLM 5000® comes in a variety of grades for different applications

- HLM 5000® SL (self-leveling) is formulated for application by squeegee to horizontal areas
- HLM 5000® T (trowel) is formulated for application by trowel to vertical surfaces
- HLM 5000® S (spray) is a specially formulated version of 5000T for spray application.

- HLM 5000® R (roller) is formulated for application by roller to vertical and some horizontal surfaces
- Companion products to HLM 5000® are Primer 733 or 766, used for priming metal to be covered by HLM 5000® and Reducer 990, used to clean tools and equipment.

PACKAGING

HLM 5000® SL, S, and R

- 5 gallon pails, 55 gallon drums are available on special order
- HLM 5000® T
- 5 gallon pails only

TECHNICAL DATA

Compliances

- ASTM C 836
- National standard of Canada 37.58-M86 developed by CGSB

COVERAGE	
Wet mil thickness	Sq. ft. per gallon
55-65	25 to 30
Dry mil thickness	Sq. ft. per gallon
45-55	25 to 30

Note: Coverage may vary with the application technique used. Actual coverage rate and mil thickness depend on finish and porosity of the substrate.

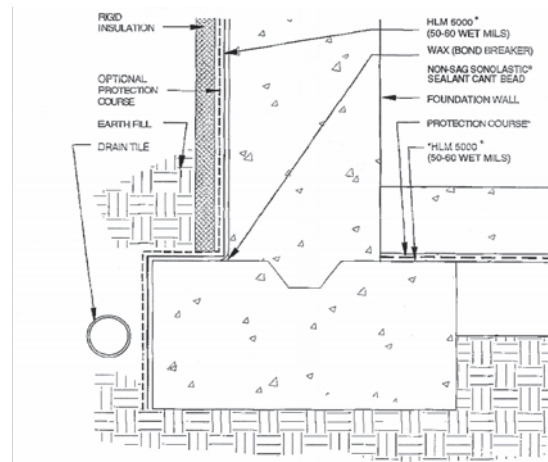

WATERPROOFING FOUNDATION WALLS

SONOLASTIC®
SOFT BACKER-ROD
Joint Filler and Backing for Sealants

FEATURES

- Nongassing when punctured
- Reticulated closed-cell polyethylene foam
- Inert
- Conforms to irregular joints
- Nonimpregnated, nonstaining, and nonbleeding
- Sealants will not adhere

BENEFITS

- Eliminates bubbling of sealant
- Low moisture absorption
- Compatible with cold-applied sealants
- Installs easily and quickly
- Will not discolor sealant or substrates
- No additional bondbreaker required

How to Apply

1. Soft Backer-Rod must be compressed in the joint at the time of installation. Soft Backer-Rod may be easily installed to the desired depth with a blunt probe or a plain-faced roller. A template or roller gauge may be used as a guide to control the depth.
2. The diameter of the rod should be approximately 25% larger than the width of the joint (see coverage table).

Coverage	
Estimating Soft Backer-Rod Requirements	
Rod Diameter	Linear ft. per Carton
3/8"	3,600*
5/8"	1,550
7/8"	850
1 1/8"	500
1 1/2"	552**
2"	360**
2 1/2"	240**
3"	144**
4"	90**

* Supplied as two 1,800 foot reels
** Supplied as 6 foot lengths

WATERPROOFING