

## BITUTHENE® MASTIC

### Description

Bituthene Mastic is a rubberized, asphalt-based mastic. It has excellent adhesion to structural concrete & masonry. Available in quart tubes or 5 gallon pails.

### Use

Bituthene Mastic is designed to seal terminations, edges of patches and overlaps in detail areas. On vertical applications, the mastic must be applied to both the top and bottom terminations, using a caulk gun or trowel.

### Limitations

Bituthene Mastic is an integral part of the Bituthene waterproofing system. This mastic should not be applied where it will be covered with Bituthene waterproofing membrane, except as permitted as a temporary cutoff.

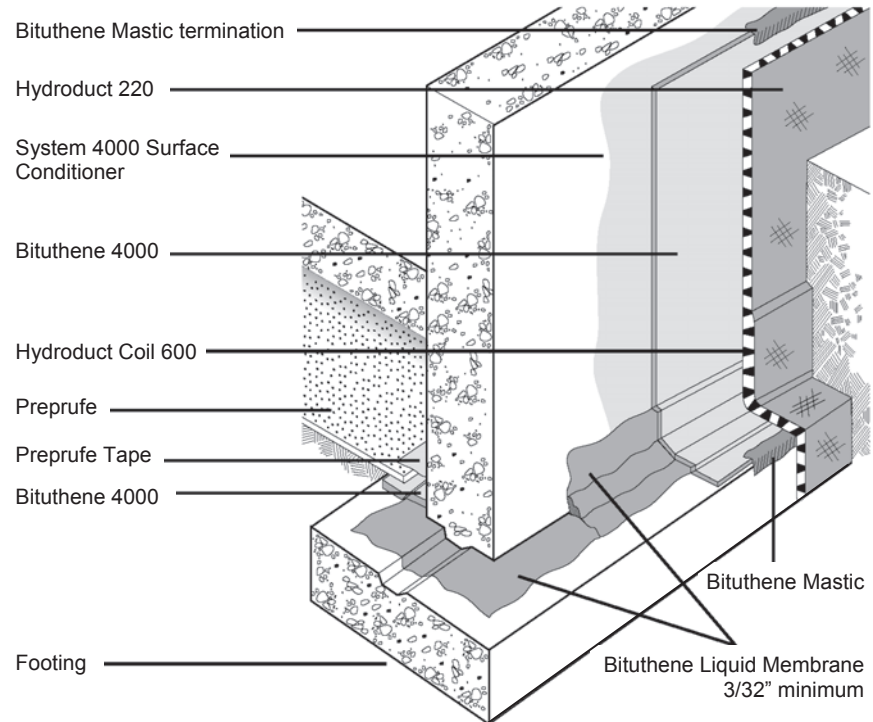

## BITUTHENE® PRIMER B2

**For use with Bituthene Membranes and Grace underlayments on “green” concrete or damp substrates**

### Description

Bituthene Primer B2 is a rubber-based primer in solvent specially formulated to provide good initial adhesion of Bituthene waterproofing membranes and Grace underlayments. In addition, its patented formulation promotes the adhesion of Bituthene membranes to “green” concrete and damp surfaces. Bituthene Primer B2 may be applied by roller or brush to a clean surface at a coverage rate of 250-350 sq. ft. per gallon. Do not apply to frozen concrete or to areas with standing or visible water. Allow Bituthene Primer B2 to dry one hour or until tack-free. In general priming should be limited to an area that can be covered with membrane within 24 hours. Areas that accumulate significant amounts of dust or dirt must be reprimed before membrane is applied.

### PACKAGING & COVERAGE

5 Gallon Pails  
Coverage: 250-350 sq. ft. per gallon